

ONE BEDROOM  
1 FULL BATHROOM  
550 to 600 SQUARE FEET

Features:

Ultra-Sustainable Passive House Design

High Ceilings

Advanced Climate Control

Purified Air

European Appliances

LIVE SOLIS.COM

SOLTERRA

SOLTERRA.COM

## X05 FLOOR PLAN

1300 East Pike Street | Seattle, WA

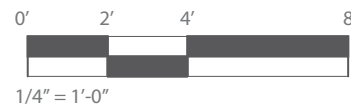
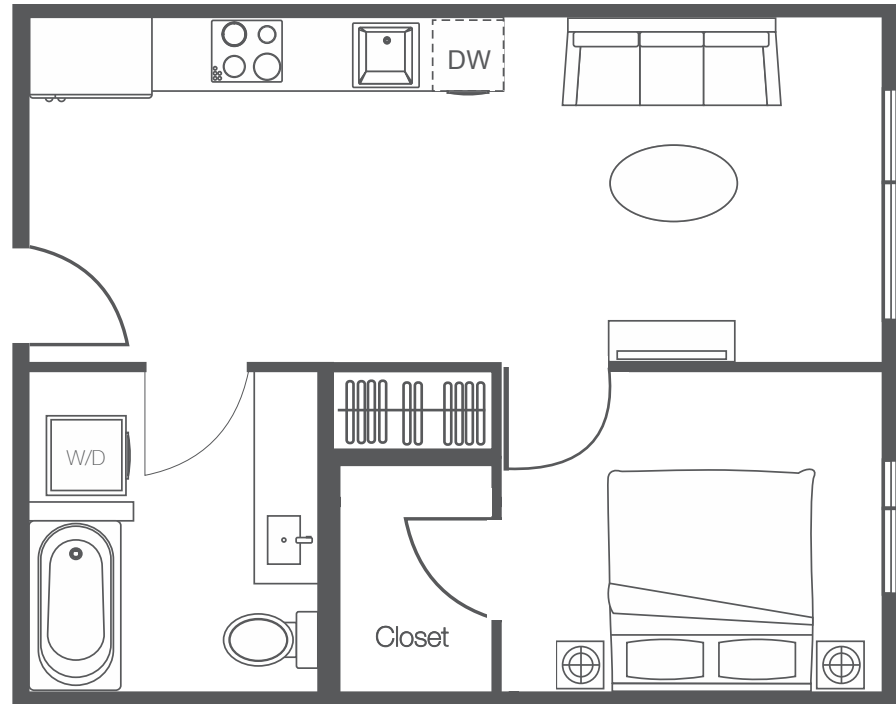

NORTH

